

Note: Please read the user manual carefully prior to using the Azulle Link remote in order to prevent damages to the product and to enjoy the best performance.

Introduction

The Azulle Link is a PC multifunctional remote control. Designed to provide the user with a unique and capable tool to operate their computer, smart TV, media streaming devices and many others. The Link offers a simple and smooth experience with its plug and play set up. It comes with an integrated mini QWERTY backlight keyboard, 2.4 GHz wireless mouse, IR remote, 6 axis Gyroscope technology and microphone for audio chat capability with speech recognition software.

This product can be used as an accessory for devices supporting Windows, Android, Mac OS, and/or Linux.

For more product information, please visit our website at www.azulletech.com

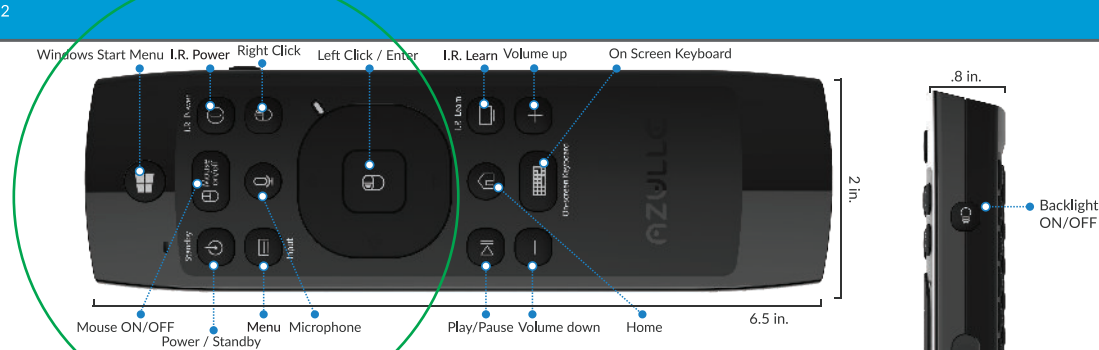

Front and Side Keys Functions

BUTTON	IR PROGRAMMABLE	FUNCTION
Windows		Windows button
Mini PC Power	Yes	Mini pc standby
Mouse on/off		Wireless mouse on/ off
I.R. Power	Yes	I.R. Power learning
Menu	Yes	Menu
Mic		Mic on/ off

Front Keys Functions

BUTTON	IR PROGRAMMABLE	FUNCTION
Return/Mouse_R	Yes	Mouse Right button / Return
D-pad up	Yes	Up
D-pad left	Yes	Left
D-pad center Button	Yes	Enter/ Mouse Left
D-pad Right	Yes	Right
D-pad Down	Yes	Down

Front Keys Functions

BUTTON	I.R. PROGRAMMABLE	FUNCTION
Play/Pause	Yes	Play/ Pause
Home	Yes	Home
I.R. Learn		I.R. Learning or I.R.on/off
Volume [-]	Yes	Volume down
On-screen keyboard		On-screen keyboard
Volume [+]	Yes	Volume up

Front Keys Functions

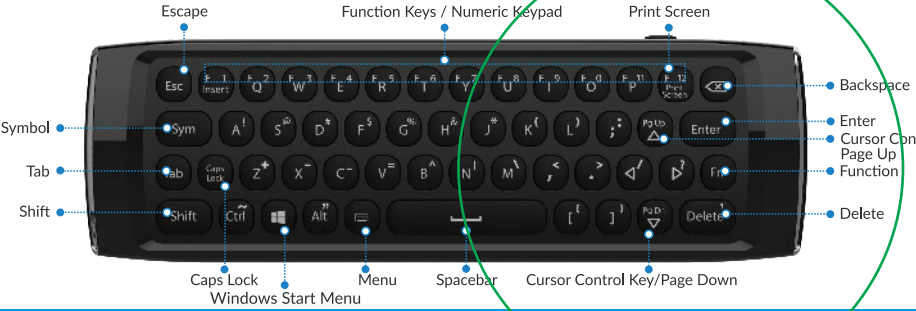

Back Keys Functions

BUTTON MAIN OUTPUT	BUTTONS COMBINATION OUTPUTS	BUTTON COMBINATIONS
Esc		Esc
Insert	1 / F1	Sym + Insert = 1/ Fn + Insert = F1
Q	2 / F2	Sym + Q = 2/ Fn + Q = F2
W	3 / F3	Sym + W = 3/ Fn + W = F3
E	4 / F4	Sym + E = 4/ Fn + E = F4
R	5 / F5	Sym+ R = 5/ Fn + R = F5

Back Keys Functions

BUTTON MAIN OUTPUT	BUTTONS COMBINATION OUTPUTS	BUTTON COMBINATIONS
T	6 / F6	Sym + T = 6/ Fn + T = F6
Y	7 / F7	Sym + Y = 7/ Fn + Y = F7
U	8 / F8	Sym + U = 8/ Fn+ U = F8
I	9 / F9	Sym + I = 9/ Fn + I = F9
O	0 / F10	Sym +O = 0/ Fn + O = F10
P	F11	Fn + P = F11

Back Keys Functions

BUTTON MAIN OUTPUT	BUTTONS COMBINATION OUTPUTS	BUTTON COMBINATIONS
Print Screen	F12	Fn + Print Screen = F12
Backspace		Backspace Fn activates the function keys (F1-F12)
Fn		
A	!	Sym + A= !
S	@	Sym + S = @
D	#	Sym + D = #

Back Keys Functions

BUTTON MAIN OUTPUT	BUTTONS COMBINATION OUTPUTS	BUTTON COMBINATIONS
F	\$	Sym + F = \$
G	%	Sym +G = %
H	&	Sym + H = &
J	*	Sym + J = *
K	(Sym + K = (
L)	Sym + L =)

Back Keys Functions

BUTTON MAIN OUTPUT	BUTTONS COMBINATION OUTPUTS	BUTTON COMBINATIONS
;	:	Sym + ; = :
Up Arrow	Pg_Up	Sym + up arrow = Page up
Enter		Enter/ Confirm
Tab		Tab
Caps Lock		Caps lock
Z	+	Sym + Z = +

Back Keys Functions

BUTTON MAIN OUTPUT	BUTTONS COMBINATION OUTPUTS	BUTTON COMBINATIONS
X	-	Sym + X= -
C	_	Sym + C = _
V	=	Sym + V = =
B	^	Sym + B = ^
N		Sym +N =
M	\	Sym + M = \

Back Keys Functions

BUTTON MAIN OUTPUT	BUTTONS COMBINATION OUTPUTS	BUTTON COMBINATIONS
,	<	Sym + , = <
.	>	Sym + . = >
Left arrow	/	Sym + left arrow = /
Right arrow	?	Sym + right arrow = ?
Sym		Press to activate symbol keys
Shift		Shift

Back Keys Functions

BUTTON MAIN OUTPUT	BUTTONS COMBINATION OUTPUTS	BUTTON COMBINATIONS
Ctrl	~	Sym + Ctrl = ~
Windows		Windows
Alt	"	Sym + Alt = "
menu		menu
Space		Space
[{	Sym + [= {

Back Keys Functions

BUTTON MAIN OUTPUT	BUTTONS COMBINATION OUTPUTS	BUTTON COMBINATIONS
]	}	Sym +] = }
Down arrow	Pg_Down	Sym + down arrow = Page_Down
Delete	'	Sym + Delete = '

Back Keys Functions

LED COLOR	INDICATES
White LED	I.R. functions and I.R. mode
Blue LED	2.4G connection mode
Red LED	battery is running low

LED Indication

LED FLICKER INDICATOR	ACTION
1Hz	1 flash per second
4Hz	4 flashes per second
8Hz	8 flashes per second

TYPE OF FLASHES
1 long light indicator
light flashes once
1Hz slow flash
4Hz continuous flashing
8Hz continuous flashing

*Indicator flash definition standard: Using Hz as a flashing standard.

LED Indication

HOW TO PAIR WITH THE RECEIVER

In any mode, press the "Volume up [+]" button" and the "Volume down [-]" button" on the front of the device for 3 seconds. The LED will flash fast continuously at 8Hz. The default searching time is set to 2 minutes. Press any button in 2.4G mode along with the "I.R. Power" button and the "I.R. Learn" button, when the Blue LED 4Hz flashes it means that it's not paired, and it is in normal use of infrared mode.I.R. Power button only sends infrared codes.

SWITCH BETWEEN 2.4G MODE AND I.R. MODE

Press the "I.R. Learn" button once to switch from the 2.4 GHz mode to infrared mode or vice versa. The LED will flash either Blue or White. If the LED flashes Blue, it is in 2.4 GHz. If the LED flashes White, it is in I.R.mode.

WIRELESS MOUSE MODE

In 2.4G mode, which is the standard mode, press the "Mouse on/off" button to turn on the Gyro sensor. This will turn ON the wireless mouse. Press it again to turn OFF the wireless mouse.

How to use

ADJUST WIRELESS MOUSE MOVING SPEED

SPEED UP

1. Press the "Menu" button and the "Volume [+]" button simultaneously to activate the speed up adjustment mode. When the Blue LED light stays on, the speed up adjustment mode is activated.
- 2.Release the "Volume [+]" button, but still press and hold on the "Menu" button, press the "Volume [+]" button once, the Blue LED light flash once, and the speed will move up one speed. When it reaches its limit, it will flash 3 times.
3. Release the "Menu" and "Volume [+]" buttons to exit speed up adjustment mode.

SLOW DOWN

1. Press the "Menu" button and the "Volume [-]" button simultaneously to activate slow down adjustment mode. When the Blue LED light stays on, the slow down adjustment mode is activated.
- 2.Release the "Volume [-]" button, but still press and hold on the "Menu" button, then press the "Volume [-]" button once, the Blue LED light flashes once, and the speed will move down one speed. When it reaches its limit, it flash 3 times.
3. Release the Menu and Volume - to exit slow down adjustment mode.

How to use

I.R.POWER LEARNING

1. In any mode, press the I.R. Learn button for 3 seconds, the White LED will flash for 3 seconds, this will set the device into I.R. learning mode.
2. Then choose the button on the Link remote that you want to learn the function and press it once. The LED will flash white, faster than before, indicating that the Link is ready to learn the I.R. code from the other remote. At this point, if there is no operation for 10 seconds, it will exit the learning process for this button.
3. Point the head of the Azulle Link remote and the head of the remote you want to learn the I.R. code from directly at each other. (The head being the part of the remote that you usually point at the device you want to control).
4. Choose the button of the function that you want the Azulle Link remote to learn and at this time keep the other I.R. remote close to the Link remote (within 20cm distance), then press the button several times on the other remote. The LED will keep flashing fast, which means it is learning the I.R. code of the other remote. When the LED flashes slower, it successfully learned the I.R.
5. At this time press the I.R. Learn button once again to take it out of learning mode. In order to use the I.R. function that you just taught the Link remote you must first put the Link remote in to I.R. mode.

The I.R. learning mode will stop on its own if there is no operation for 30 seconds

How to use

I.R.POWER LEARNING (CONT.)

For example, if you would like to learn a TV's remote power button for this Link remote, on its I.R. Power button.

1. Press the I.R. Learn button for 3 seconds, the White LED will flash slowly.
2. Press the I.R. Power button once. The White LED will flash faster than before.
3. Put the TV's remote within 7 inches away from the Link remote. Keep pressing the power button on the TV's remote, the White LED will keep flashing, which means it is learning the I.R. Power button. While it successfully learns the TV power button, it will flash slower.

TO RESET TO FACTORY DEFAULT SETTINGS

In I.R. mode, press the "Home" button and the "Enter" button in front of the Link at the same time for 3 seconds, the White LED light will flash quickly for 5 seconds, indicating that the restore to factory settings request is complete.

How to use

TO FORCE THE MOTION CALIBRATION

In 2.4G mode, press "Menu" button and "PLAY/PAUSE" on the front of the Link at the same time for 3 seconds, the Blue LED light stays on, then place the Link flat on an even desk or surface. When it is successful, the Blue LED stays on for 3 seconds then it turns off, and the device is calibrated.

STANDBY MODE

- For power saving, this remote has auto sleep function.
1. If the remote is not in used for 3 minutes, it will go into standby/ sleep mode.
 2. For the back light, if there are no keys pressed for 6 seconds then the light is turned off.

How to use